

**This electronic collection of documents is provided
for the convenience of the user
and is Not a Certified Document –**

**The documents contained herein were originally issued
and sealed by the individuals whose names and license
numbers appear on each page, on the dates appearing
with their signature on that page.**

**This file or an individual page
shall not be considered a certified document.**

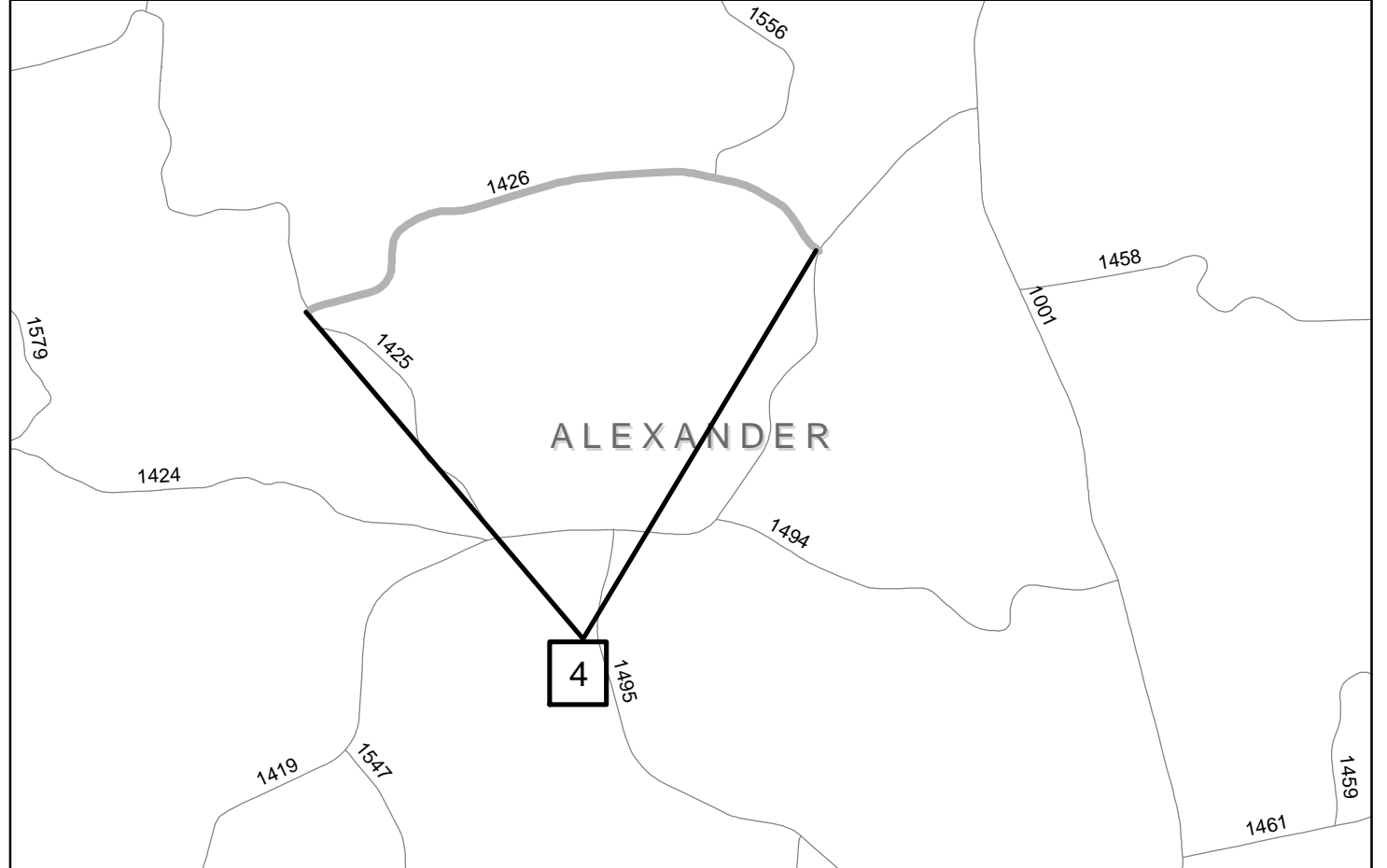

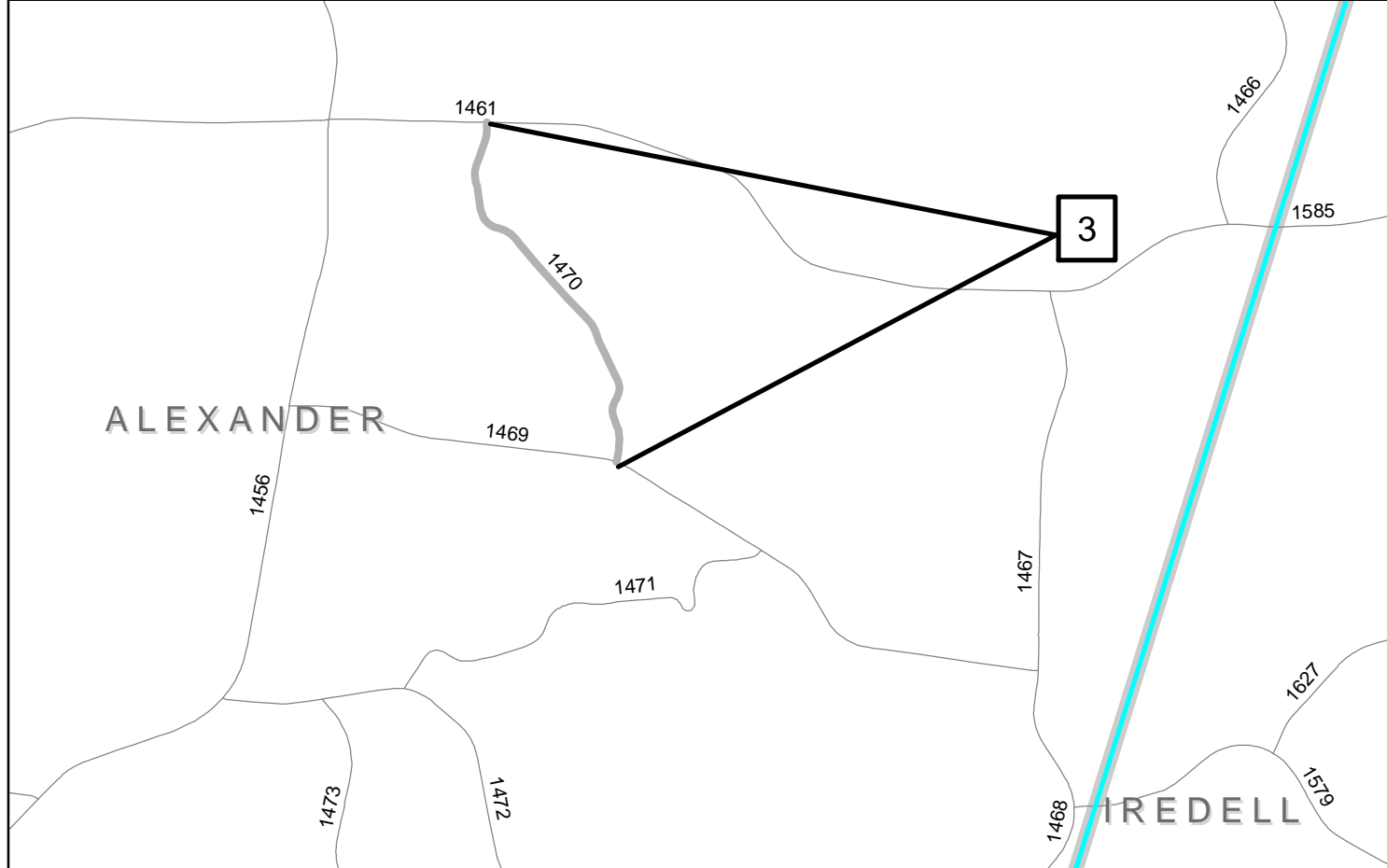
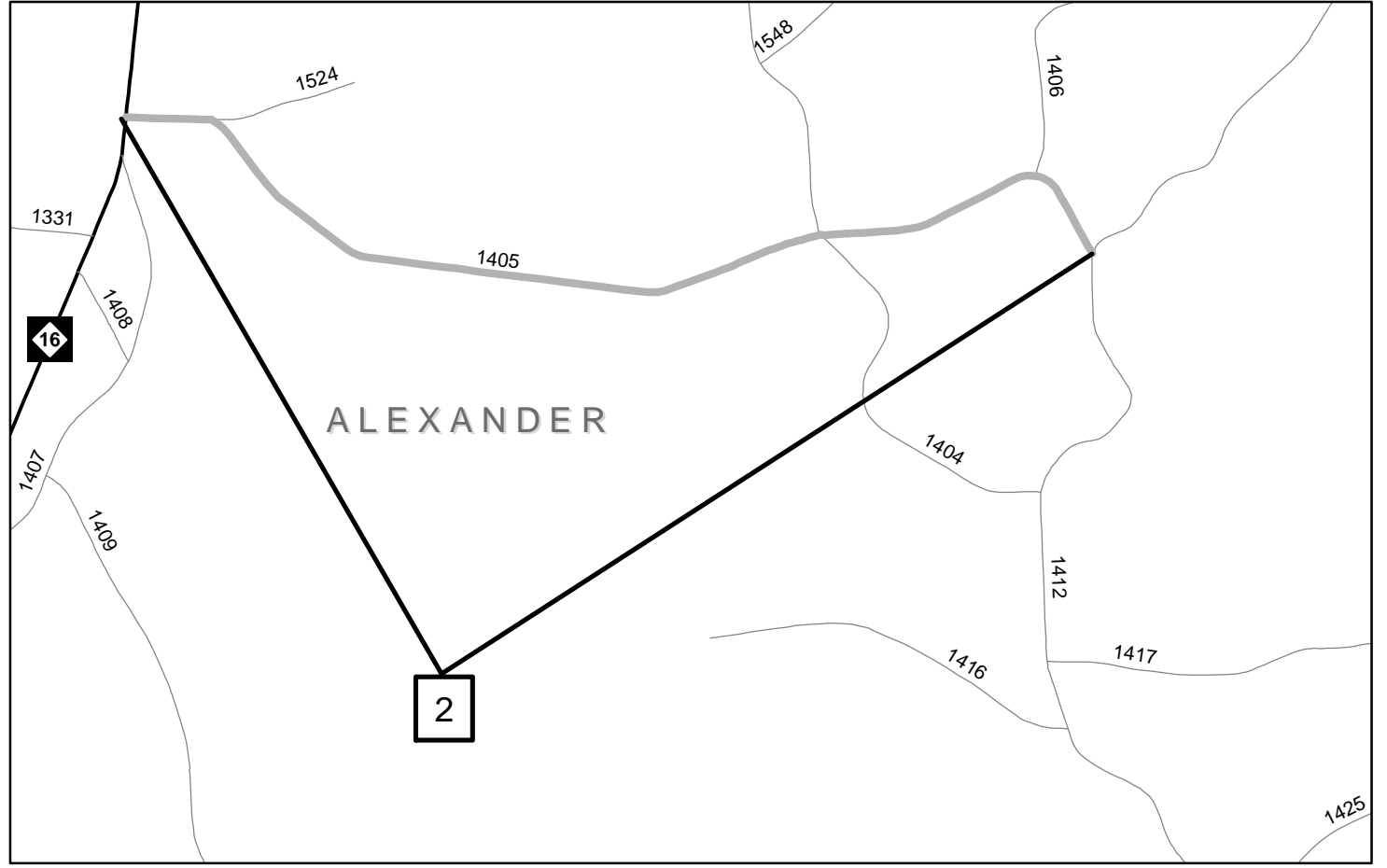
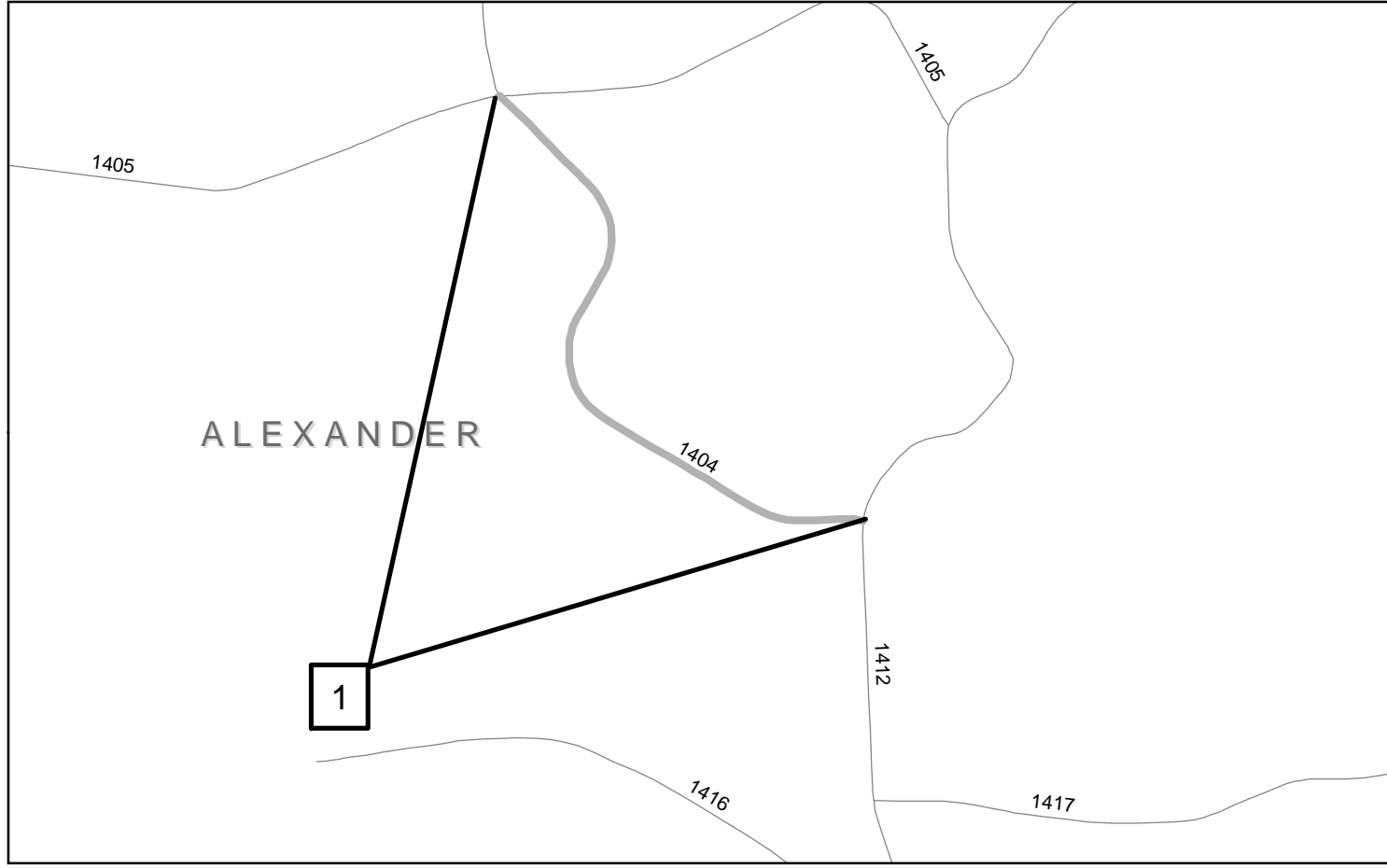
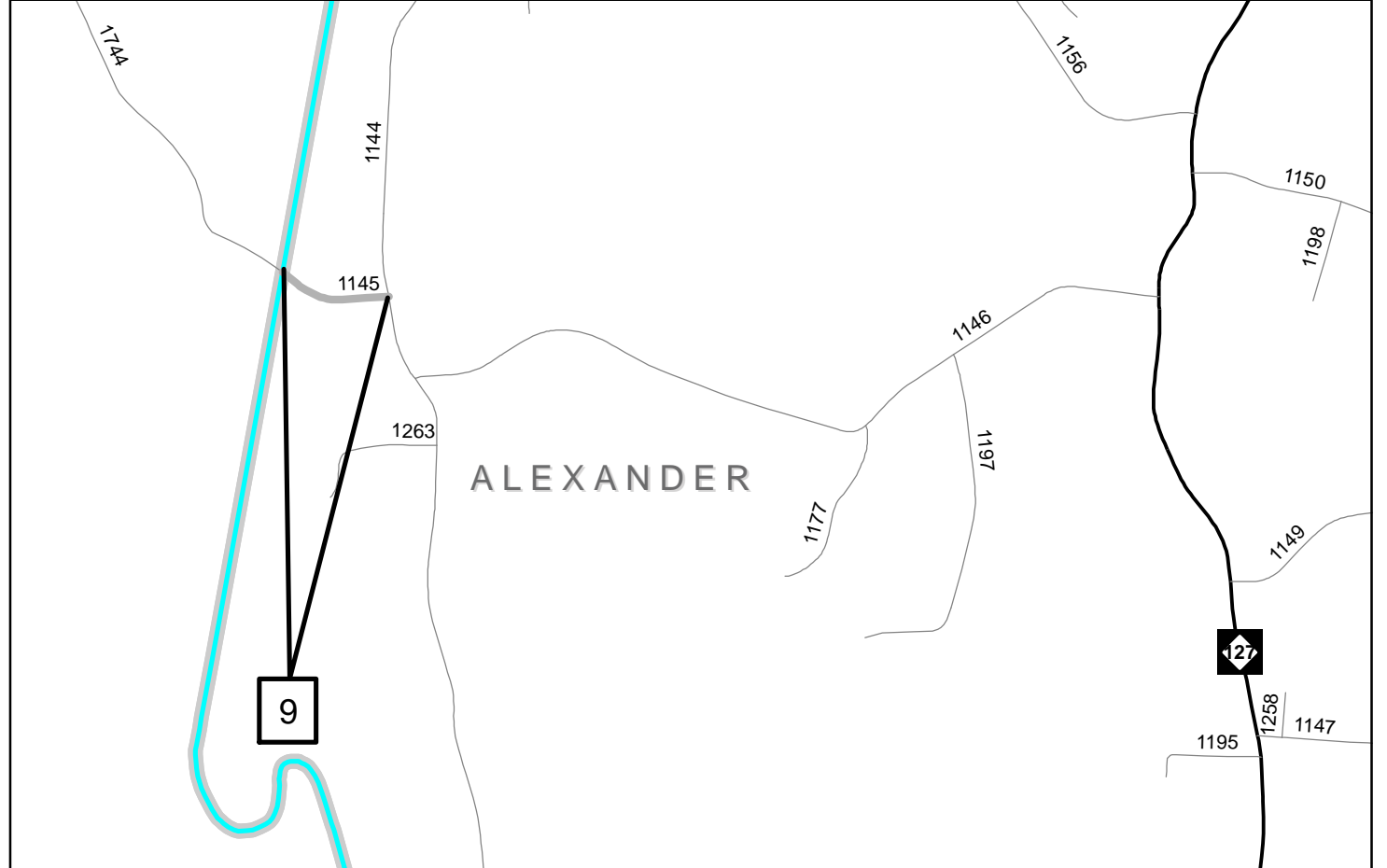
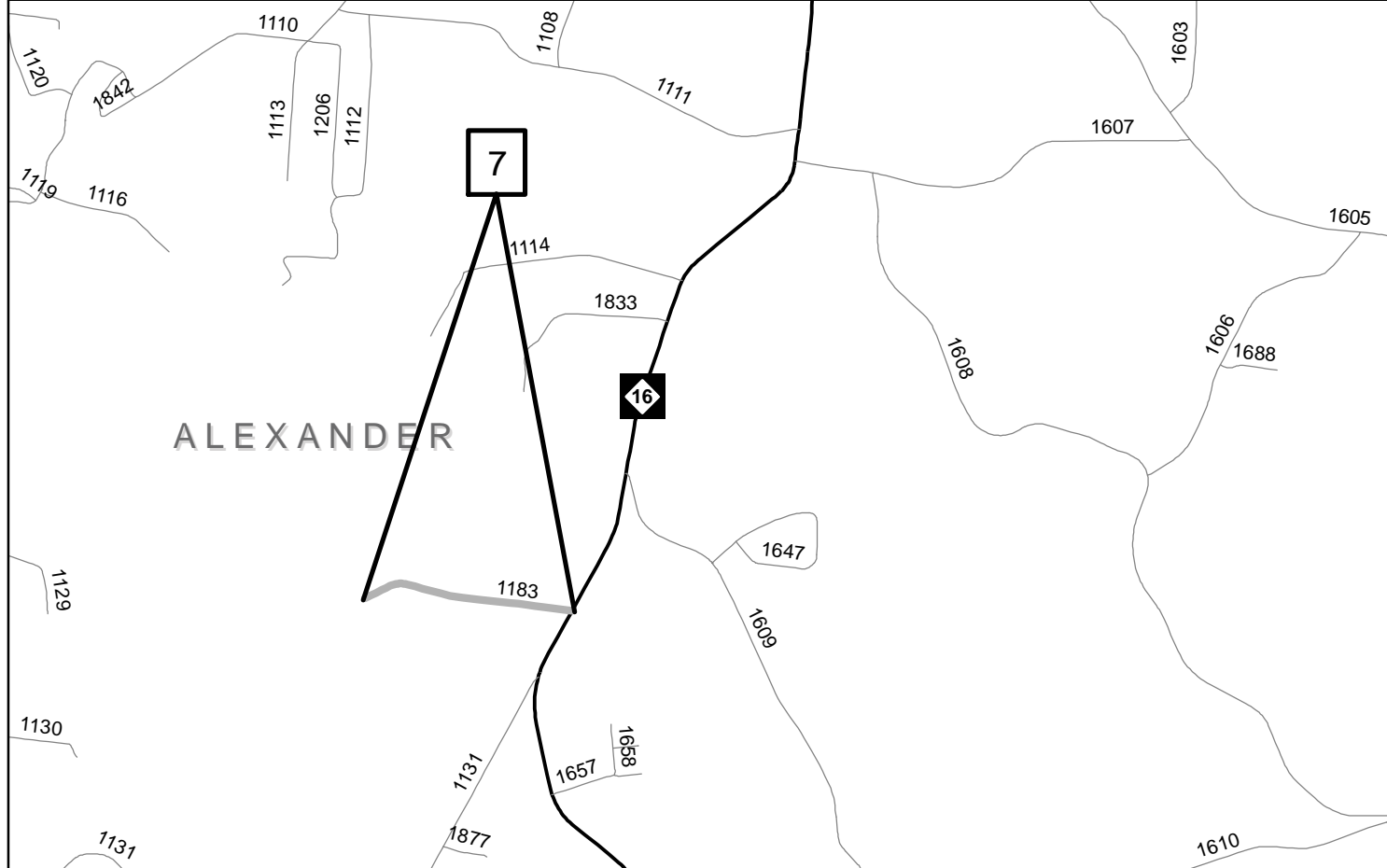
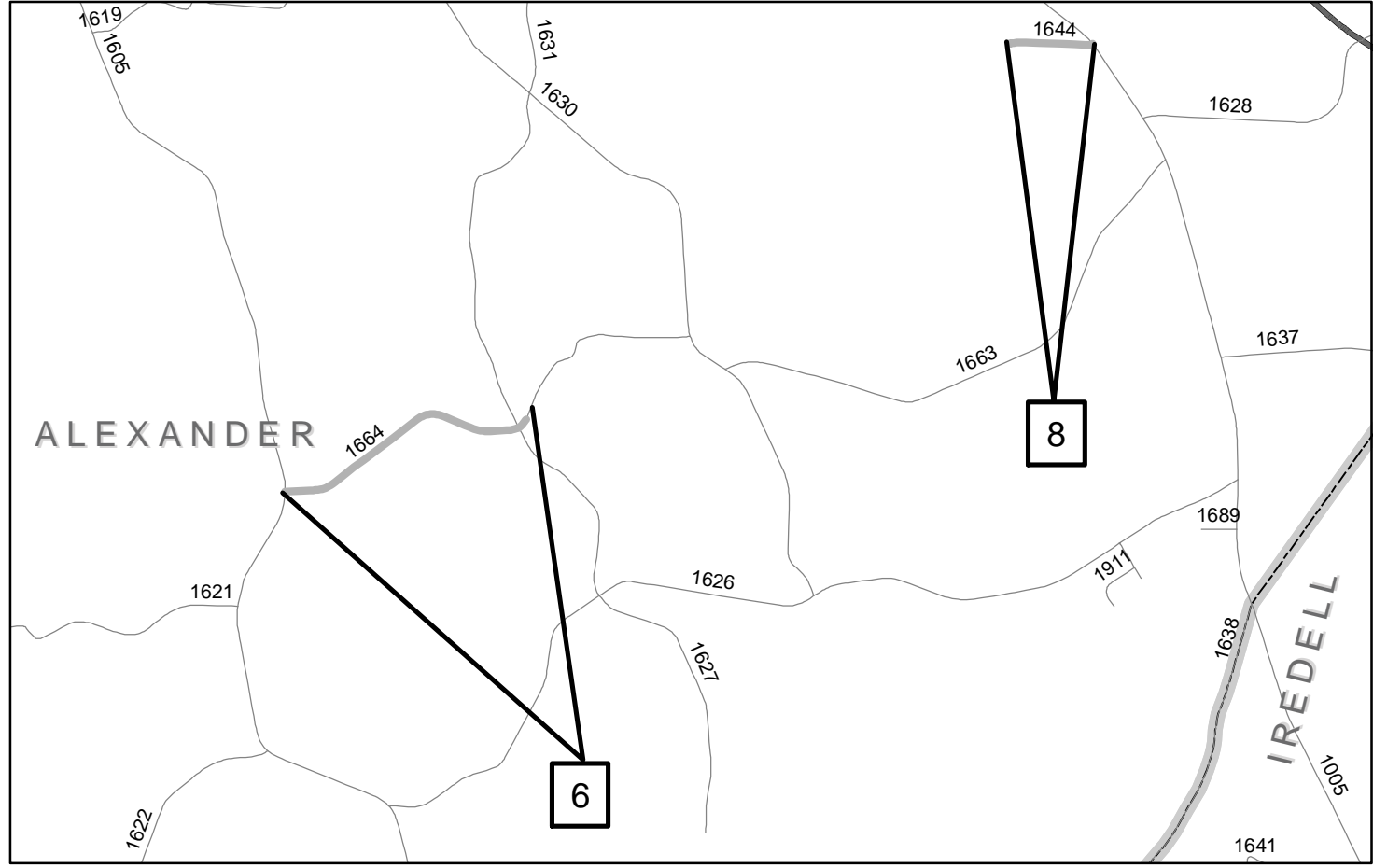
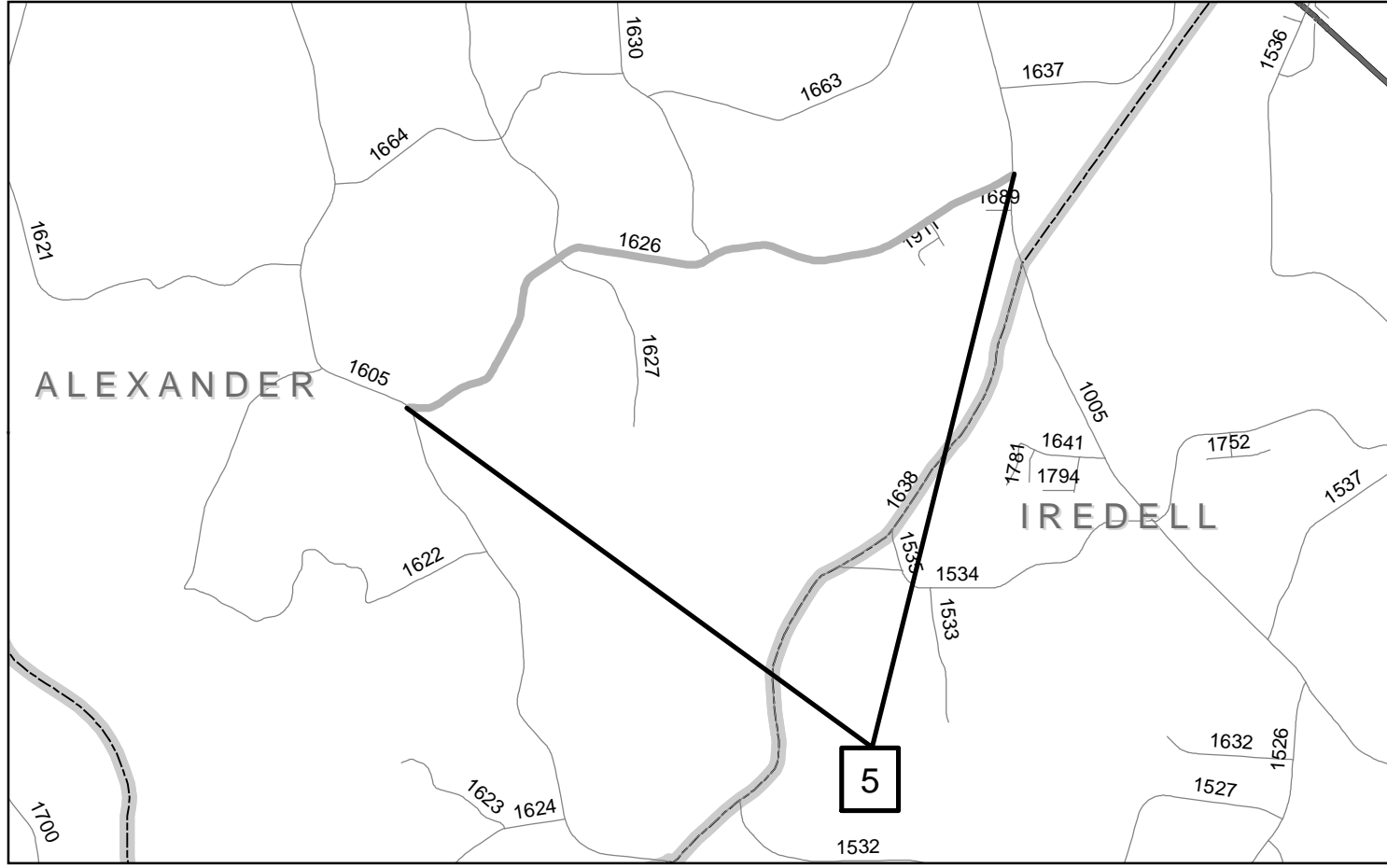

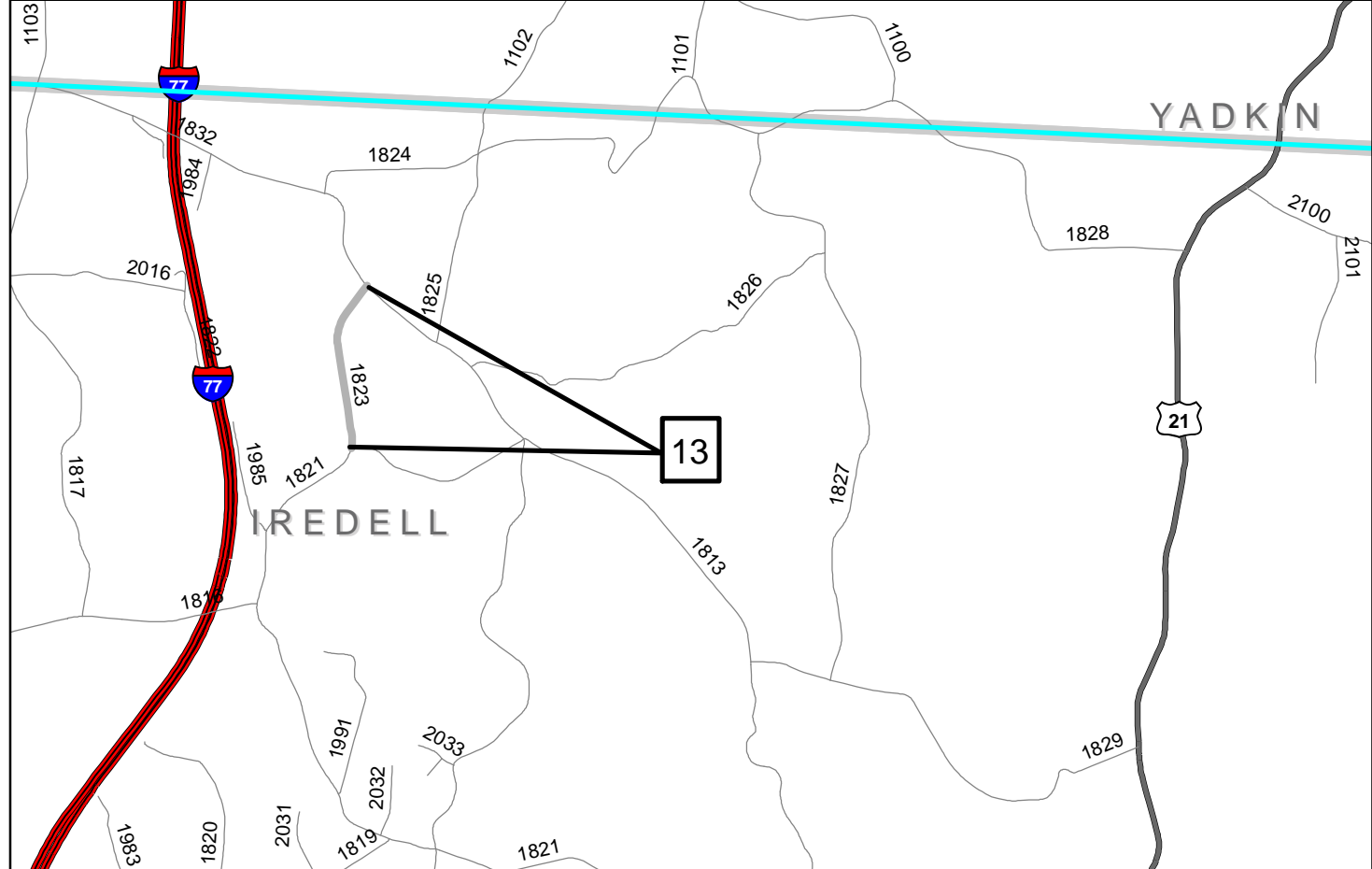
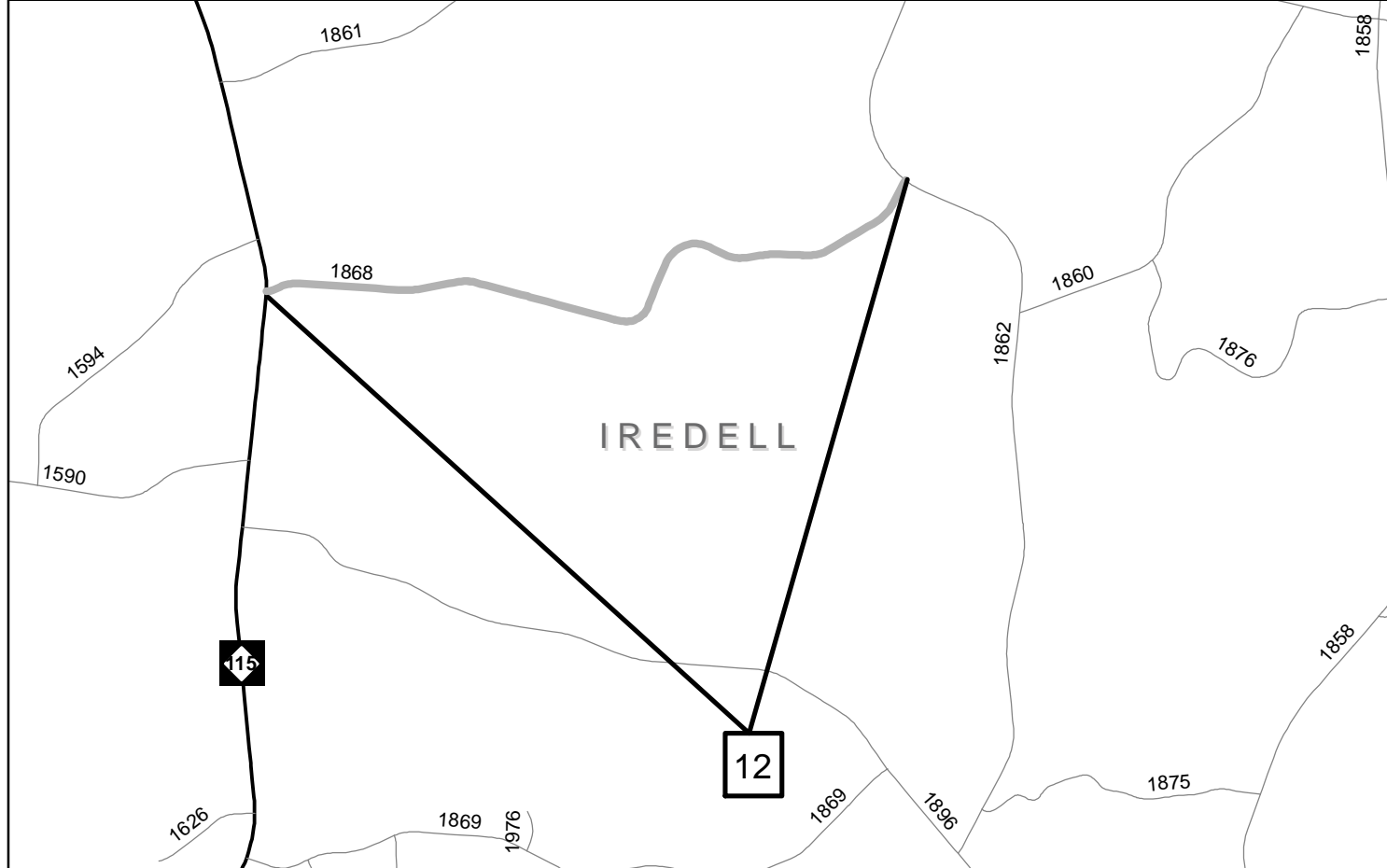
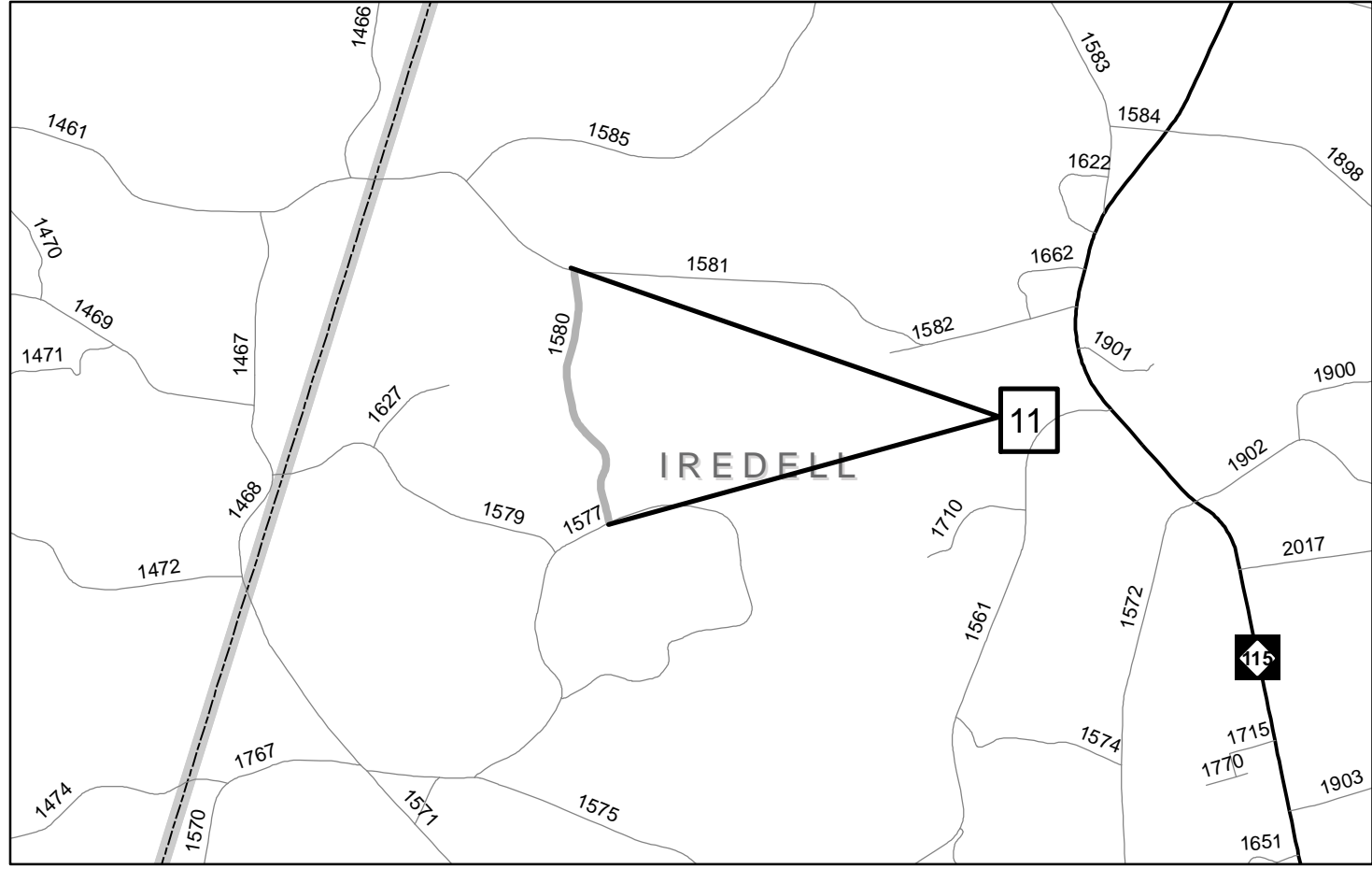
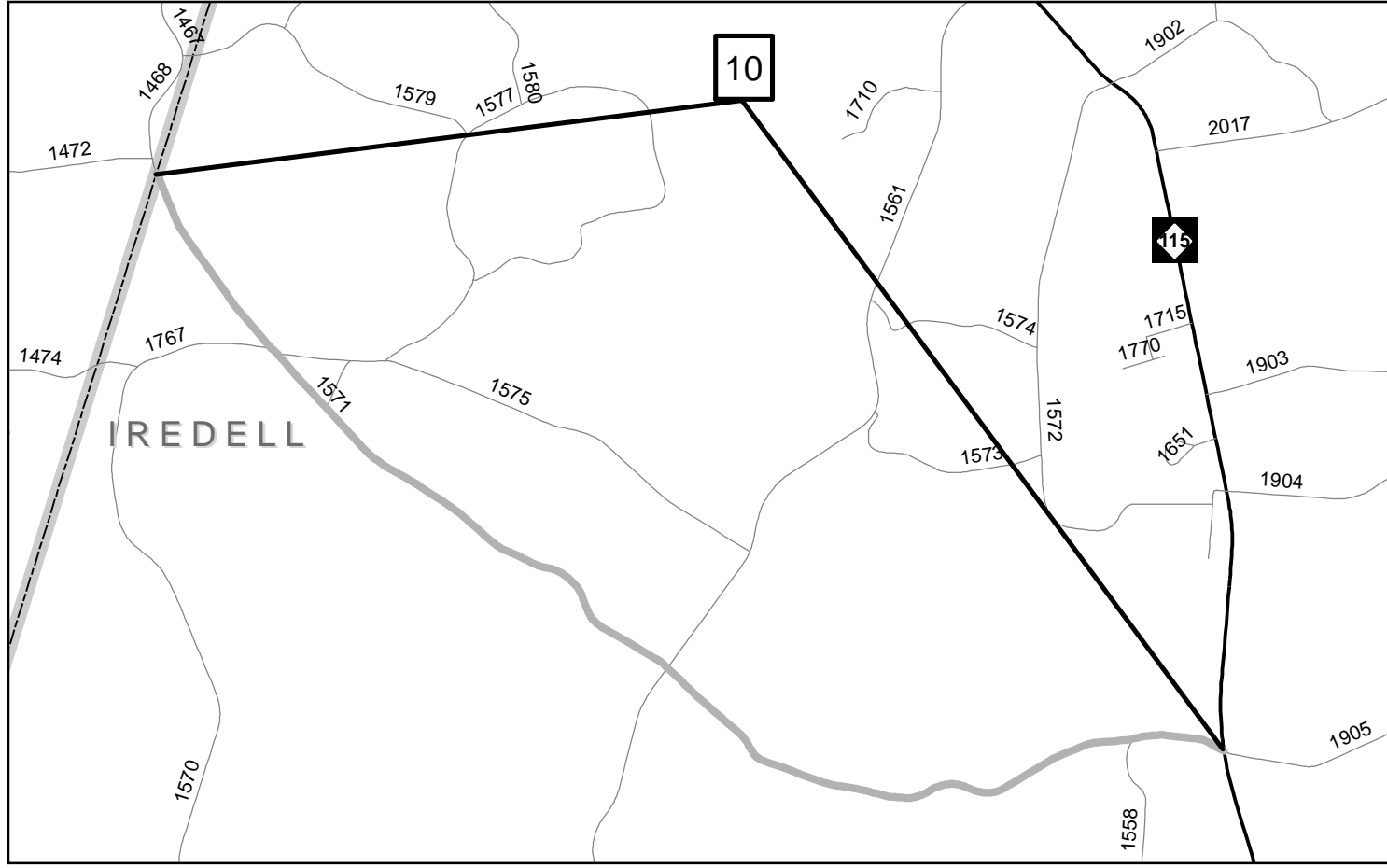

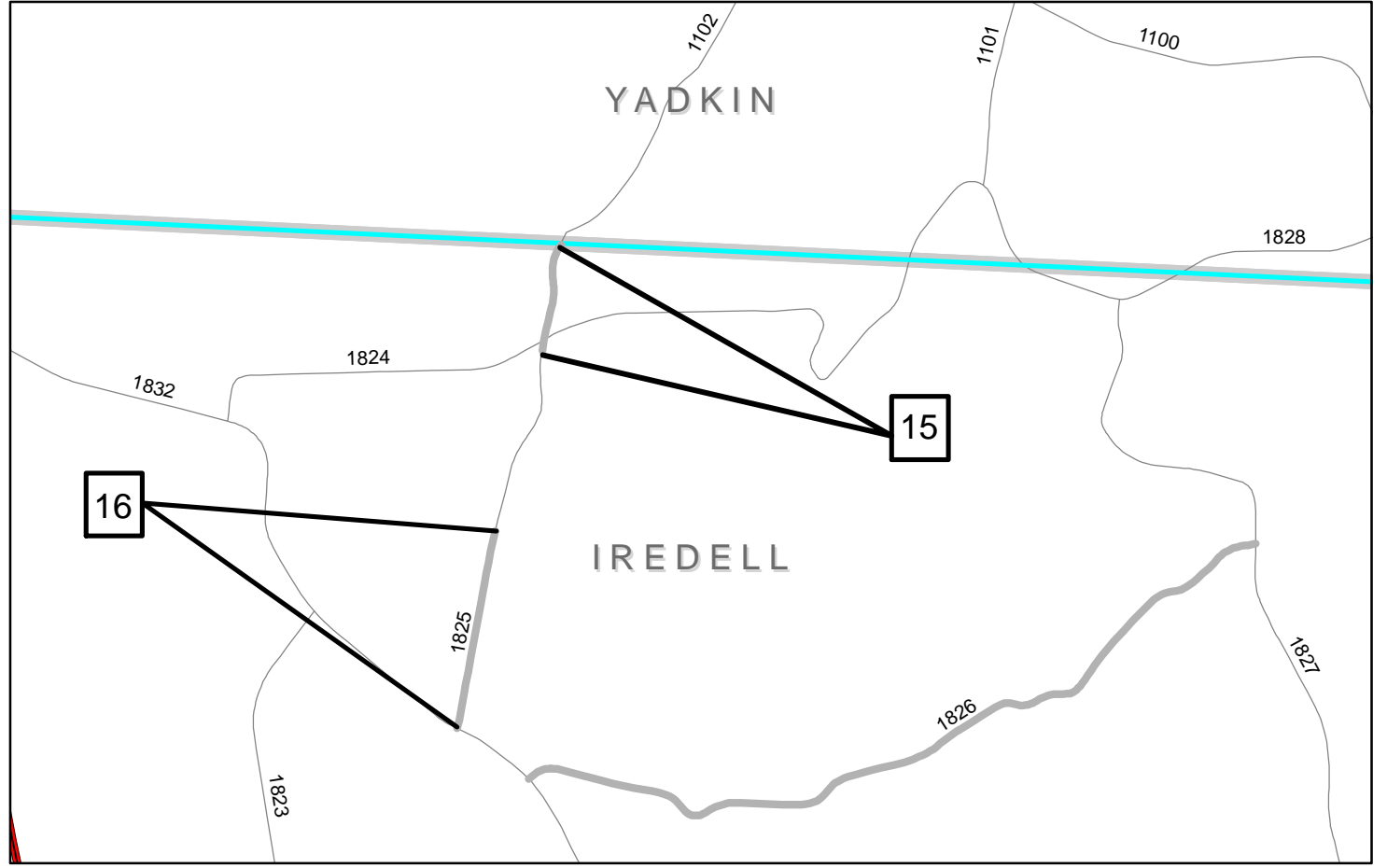
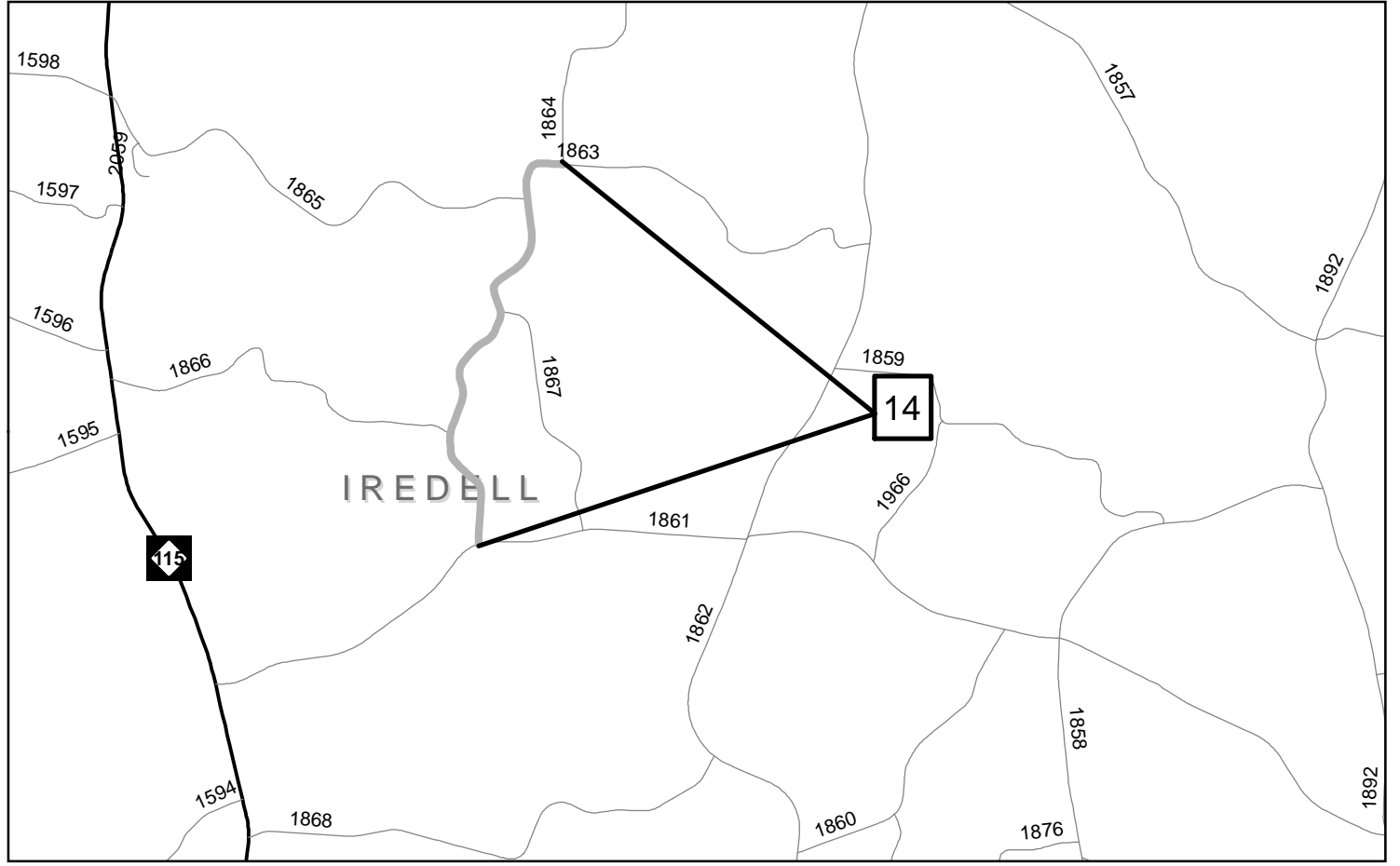

PAVEMENT SCHEDULE

STATE	PROJECT WBS	SHEET NUMBER
NC	2024CPT.12.10.20022	6
	2024CPT.12.10.20492	

F	ASPHALT SURFACE TREATMENT, DOUBLE SEAL, USING A TOP LIFT OF LIGHTWEIGHT AGGREGATE AND A BOTTOM LIFT OF 78M AGGREGATE.
G	ASPHALT SURFACE TREATMENT, FOG SEAL, WITH A TARGET APPLICATION RATE OF 0.12 GAL/SY, +/- 0.03 GAL/SY.

Checked by:
Drawn by: J. Barnette

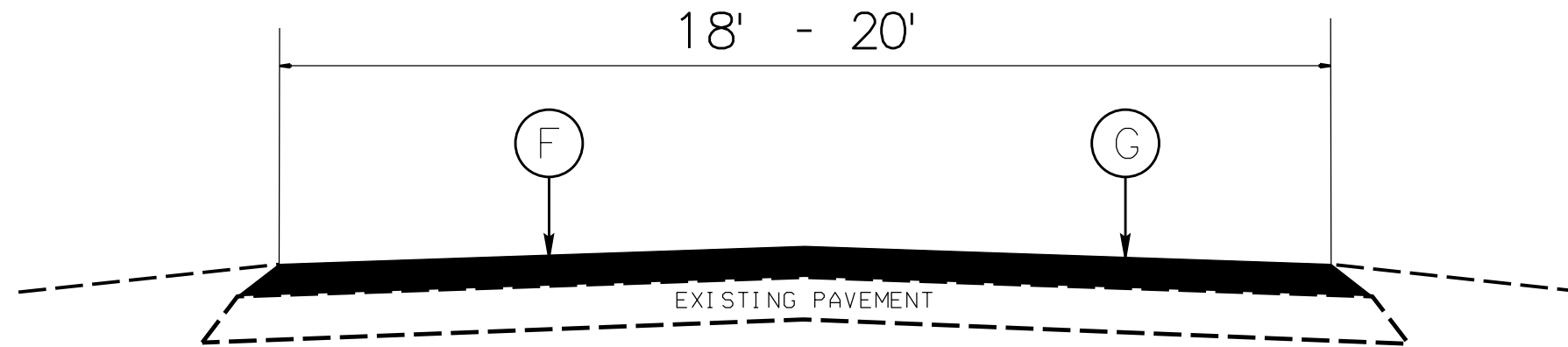

TYPICAL SECTION NO. 1

Typical Section
 Alexander & Iredell Co.
 2024-2025 Pvmt. Preservation

PROJECT NO.	SHEET NO.	TOTAL NO.
2024CPT.12.10.20022		
2024CPT.12.10.20492		

SUMMARY OF QUANTITIES

PROJECT NO	COUNTY	MAP NO	ROUTE	DESCRIPTION	TYP NO	LANES	LENGTH	WIDTH	1803500000-E	1820000000-E	1838000000-E	2143000000-E
									ASPHALT SURFACE TREATMENT, DOUBLE SEAL	ASPHALT SURFACE TREATMENT, FOG SEAL	EMULSION FOR ASPHALT SURFACE TREATMENT	BLOTTING SAND
									SY	SY	GAL	TON
2024CPT.12.10.20022	Alexander	1	SR-1404 / DANIELS LUMBER RD	FROM SR 1405 (JOLLY CEMETARY RD.) TO SR 1412 (BLACK OAK RIDGE RD.)	1	2	0.75	19	9,200	9,200	4,784	5
2024CPT.12.10.20022	Alexander	2	SR-1405 / JOLLY CEMETERY RD	FROM NC 16 TO SR 1412 (BLACK OAK RIDGE RD.)	1	2	1.983	18	23,000	23,000	11,960	20
2024CPT.12.10.20022	Alexander	3	SR-1470 / TOM MEADOWS RD	FROM SR 1461 (SHARP MILL RD.) TO SR 1469 (CHARLIE LACKEY RD.)	1	2	0.72	20	9,275	9,275	4,823	5
2024CPT.12.10.20022	Alexander	4	SR-1426 / ALLEN RD	FROM SR 1419 (ROCKY SPRINGS RD.) TO SR 1425 (ROCKY FACE CHURCH RD.)	1	2	1.416	19	17,400	17,400	9,048	15
2024CPT.12.10.20022	Alexander	5	SR-1626 / DRUMSTAND RD	FROM SR 1005 (OLD MTN. RD.) TO SR 1605 (PAUL PAYNE STORE RD.)	1	2	3.139	18	36,375	36,375	18,915	30
2024CPT.12.10.20022	Alexander	6	SR-1664 / MIDDLE RD	FROM END OF PAVEMENT TO SR 1605 (PAUL PAYNE STORE RD.)	1	2	0.85	19	10,400	10,400	5,408	10
2024CPT.12.10.20022	Alexander	7	SR-1183 / BEN THOMPSON LN	FROM NC 16 TO DEAD END	1	2	0.594	20	7,700	7,700	4,004	5
2024CPT.12.10.20022	Alexander	8	SR-1644 / THIRD CREEK RD	FROM SR 1005 (OLD MTN. RD.) TO DEAD END	1	2	0.259	18	3,025	3,025	1,573	5
2024CPT.12.10.20022	Alexander	9	SR-1145 / PETRA MILL RD	FROM SR 1144 (ICARD RIDGE RD.) TO CALDWELL COUNTY LINE	1	2	0.225	20	2,850	2,850	1,482	5
TOTAL FOR PROJ NO. 2024CPT.12.10.20022							9.936		119,225	119,225	61,997	100
2024CPT.12.10.20492	Iredell	10	SR-1571 / PISGAH CHURCH RD	FROM ALEXANDER COUNTY LINE TO NC 115	1	2	4.755	19	58,364	58,364	30,349	50
2024CPT.12.10.20492	Iredell	11	SR-1580 / LAUREL CREEK RD	FROM SR 1577 (PISGAH RIDGE CIRCLE) TO SR 1581 (DAMASCUS CHURCH ROAD)	1	2	0.948	20	12,261	12,261	6,376	10
2024CPT.12.10.20492	Iredell	12	SR-1868 / SPRINKLE RD	FROM SR 1862 (MYERS MILL ROAD) TO NC 115	1	2	1.866	20	24,135	24,135	12,550	20
2024CPT.12.10.20492	Iredell	13	SR-1823 / TRIVETTE RD	FROM SR 1832(UNION GROVE ROAD) TO SR 1821 (TRIVETTE ROAD)	1	2	0.602	18	6,970	6,970	3,624	5
2024CPT.12.10.20492	Iredell	14	SR-1863 / MORGAN FORD RD	FROM SR 1861 (PROSPECT ROAD) TO SR 1864 (SOUTHER ROAD)	1	2	1.619	20	20,909	20,909	10,873	15
2024CPT.12.10.20492	Iredell	15	SR-1825 / OLD WESLEY RD	FROM YADKIN COUNTY LINE TO END OF PAVEMENT	1	2	0.171	18	2,091	2,091	1,087	5
2024CPT.12.10.20492	Iredell	16	SR-1825 / OLD WESLEY RD	FROM END OF PAVEMENT TO SR 1832 (UNION GROVE ROAD)	1	2	0.35	18	4,066	4,066	2,114	5
TOTAL FOR PROJ NO. 2024CPT.12.10.20492							10.311		128,796	128,796	66,973	110
GRAND TOTAL							20.247		248,021	248,021	128,970	210.00

PROJECT NO.	SHEET NO.	TOTAL NO.
2024CPT.12.10.20022		
2024CPT.12.10.20492		

THERMOPLASTIC AND PAINT QUANTITIES

PROJECT NO	COUNTY	MAP NO	ROUTE	DESCRIPTION	TYP NO	LANES	LENGTH	WIDTH	441300000-E	445700000-N	481000000-E	481000000-E
									WORK ZONE ADVANCE/GENERAL WARNING SIGNING	TEMPORARY TRAFFIC CONTROL	4" WHITE PAINT	4" YELLOW PAINT
									SF	LS	LF	LF
2024CPT.12.10.20022	Alexander	1	SR-1404 / DANIELS LUMBER RD	FROM SR 1405 (JOLLY CEMETARY RD.) TO SR 1412 (BLACK OAK RIDGE RD.)	1	2	0.75	19	100	*	17,500	17,500
2024CPT.12.10.20022	Alexander	2	SR-1405 / JOLLY CEMETERY RD	FROM NC 16 TO SR 1412 (BLACK OAK RIDGE RD.)	1	2	1.983	18	225	*	46,000	46,000
2024CPT.12.10.20022	Alexander	3	SR-1470 / TOM MEADOWS RD	FROM SR 1461 (SHARP MILL RD.) TO SR 1469 (CHARLIE LACKEY RD.)	1	2	0.72	20	85	*	16,750	16,750
2024CPT.12.10.20022	Alexander	4	SR-1426 / ALLEN RD	FROM SR 1419 (ROCKY SPRINGS RD.) TO SR 1425 (ROCKY FACE CHURCH RD.)	1	2	1.416	19	160	*	33,000	33,000
2024CPT.12.10.20022	Alexander	5	SR-1626 / DRUMSTAND RD	FROM SR 1005 (OLD MTN. RD.) TO SR 1605 (PAUL PAYNE STORE RD.)	1	2	3.139	18	360	*	72,750	72,750
2024CPT.12.10.20022	Alexander	6	SR-1664 / MIDDLE RD	FROM END OF PAVEMENT TO SR 1605 (PAUL PAYNE STORE RD.)	1	2	0.85	19	100	*	19,750	19,750
2024CPT.12.10.20022	Alexander	7	SR-1183 / BEN THOMPSON LN	FROM NC 16 TO DEAD END	1	2	0.594	20	75	*	13,800	13,800
2024CPT.12.10.20022	Alexander	8	SR-1644 / THIRD CREEK RD	FROM SR 1005 (OLD MTN. RD.) TO DEAD END	1	2	0.259	18	50	*		
2024CPT.12.10.20022	Alexander	9	SR-1145 / PETRA MILL RD	FROM SR 1144 (ICARD RIDGE RD.) TO CALDWELL COUNTY LINE	1	2	0.225	20	50	*	5,150	5,150
TOTAL FOR PROJ NO. 2024CPT.12.10.20022							9.936		1,205	*	224,700	224,700
2024CPT.12.10.20492	Iredell	10	SR-1571 / PISGAH CHURCH RD	FROM ALEXANDER COUNTY LINE TO NC 115	1	2	4.755	19	550	*	110,600	110,600
2024CPT.12.10.20492	Iredell	11	SR-1580 / LAUREL CREEK RD	FROM SR 1577 (PISGAH RIDGE CIRCLE) TO SR 1581 (DAMASCUS CHURCH ROAD)	1	2	0.948	20	110	*	22,100	22,100
2024CPT.12.10.20492	Iredell	12	SR-1868 / SPRINKLE RD	FROM SR 1862 (MYERS MILL ROAD) TO NC 115	1	2	1.866	20	210	*	43,500	43,500
2024CPT.12.10.20492	Iredell	13	SR-1823 / TRIVETTE RD	FROM SR 1832(UNION GROVE ROAD) TO SR 1821 (TRIVETTE ROAD)	1	2	0.602	18	75	*	14,000	14,000
2024CPT.12.10.20492	Iredell	14	SR-1863 / MORGAN FORD RD	FROM SR 1861 (PROSPECT ROAD) TO SR 1864 (SOUTHER ROAD)	1	2	1.619	20	185	*	37,750	37,750
2024CPT.12.10.20492	Iredell	15	SR-1825 / OLD WESLEY RD	FROM YADKIN COUNTY LINE TO END OF PAVEMENT	1	2	0.171	18	25	*	4,200	4,200
2024CPT.12.10.20492	Iredell	16	SR-1825 / OLD WESLEY RD	FROM END OF PAVEMENT TO SR 1832 (UNION GROVE ROAD)	1	2	0.35	18	50	*	8,150	8,150
TOTAL FOR PROJ NO. 2024CPT.12.10.20492							10.311		1,205	*	240,300	240,300
GRAND TOTAL							20.247		2,410	1	465,000	465,000

SIGNING FOR ASPHALT SURFACE TREATMENT

LEGEND

- ▷ PORTABLE SIGN
- └ STATIONARY SIGN
- ← DIRECTION OF TRAFFIC FLOW

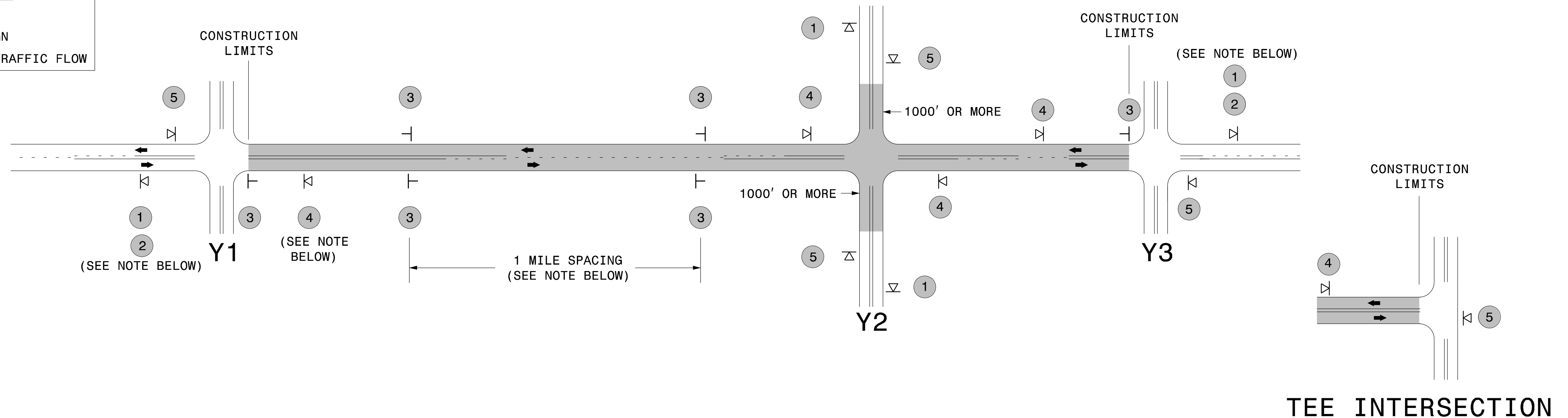

MAINLINE (-L-) SIGNING

-Y- LINE SIGNING

SIGNING NOTES AND PLACEMENT PER DIRECTION	1	 W20-1 48" X 48"	- PLACE 1000' PRIOR TO BEGINNING OF CONSTRUCTION LIMITS. ONLY USED ON -Y- LINES IF RESURFACING LIMITS EXTEND 1000' ALONG -Y- LINE.	<p>STATIONARY SIGNING NOT REQUIRED FOR THE FOLLOWING -Y- LINE CONDITIONS:</p> <ol style="list-style-type: none"> 1) LESS THAN 1000' OF RESURFACING ALONG -Y- LINE 2) SUBDIVISION ROADS 3) DEAD END ROADS <p>WHEN PAVING/CONSTRUCTION ACTIVITIES PROCEED ACROSS AN UNSIGNED -Y- LINE, PORTABLE ADVANCE WARNING SIGNS SHALL BE USED ALONG THE -Y- LINE AS SHOWN BELOW. REMOVE UPON COMPLETION OF WORK.</p> <div style="display: flex; justify-content: space-around;"> <div style="text-align: center;"> W20-1 48" X 48" </div> <div style="text-align: center;"> W20-7 A 48" X 48" </div> </div> <p>PLACED 500' IN ADVANCE OF FLAGGER. PLACED 250' IN ADVANCE OF FLAGGER.</p>
	2	 W7-3qP 24" X 18"	- SIGN #2 ONLY USED WHEN RESURFACING LIMITS ARE 2 OR MORE MILES IN LENGTH. ROUND UP TO THE NEAREST WHOLE NUMBER. DO NOT USE FRACTIONAL OR DECIMAL NUMBERS.	
	3	 W8-7 48" X 48"	- ALTERNATE THE FOLLOWING TWO SIGNS: - STARTING WITH "LOOSE GRAVEL" (W8-7) FOLLOWED BY "UNMARKED PAVEMENT". - PLACE INITIALLY AT THE CONSTRUCTION LIMITS AND SPACED 1 MILE APART THEREAFTER.	
		 SP 48" X 48"	- AT TEE INTERSECTIONS INSTALL INITIALLY 0.5 MILE FROM INTERSECTION AND SPACE 1 MILE APART THEREAFTER.	
	4	 SP 13106 48" X 48"	- THESE ARE FOR -Y- LINES THAT ARE "THROUGH" ROADWAYS. DEAD END AND SUBDIVISION ROADS ARE NOT "THROUGH" ROADWAYS. - INSTALL 500' +/- FROM EACH -Y- LINE APPROACH AS SHOWN ABOVE. - FOR MULTIPLE -Y- LINES THAT ARE SEPARATED BY 0.25 MILES OR LESS, TREAT AS A SINGLE UNIT AND INSTALL WITHIN 500' OF EACH APPROACH. - A MAXIMUM OF 2 SIGN SETS PER MILE. DO NOT INSTALL WHEN -Y- LINES ARE WITHIN 0.5 MILES FROM "END ROAD WORK" SIGN.	
5	 G20-2 A 48" X 24"	PLACE 500' FOLLOWING THE END OF CONSTRUCTION LIMITS OR AS SHOWN WHEN WORK ENDS AT A 3-WAY TEE INTERSECTION.		

THE ABOVE SIGNS ARE ALL THAT ARE REQUIRED FOR A CONTRACTOR TO BEGIN A RESURFACING CONTRACT. ANY ADDITIONAL SIGNS REQUESTED BY NCDOT DIVISIONS SHALL BE INSTALLED WITHIN 7 BUSINESS DAYS OF THE START OF CONTRACT WORK.

MAPS LESS THAN 2 MILES

FOR AST RESURFACING MAPS WITH CONSTRUCTION LIMITS LESS THAN 2 MILES IN LENGTH, USE A STATIONARY "LOOSE GRAVEL" SIGN AT THE BEGINNING CONSTRUCTION LIMIT FOLLOWED BY AN "UNMARKED PAVEMENT" SIGN MIDWAY THROUGH AND AN "END ROAD WORK" SIGN AT THE END CONSTRUCTION LIMIT.

ADVANCE WARNING SIGNS FOR 2-LANE ROADWAY ASPHALT SURFACE TREATMENT